

# INSTALLATION AND SERVICE MANUAL

For Installation of Lightsoft 20 Solar Integrated Bollard.  
Model. ULH-10821, ULH-10822 and ULH-10823

## Product drawing (dimensions)

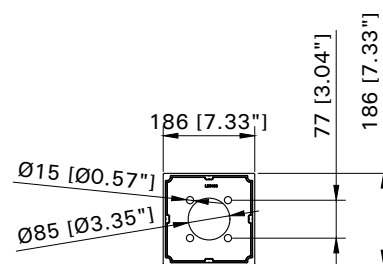
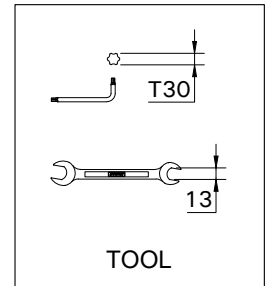
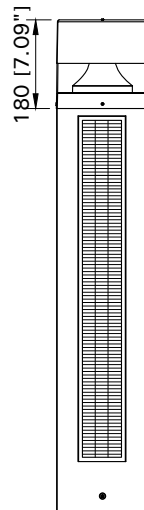
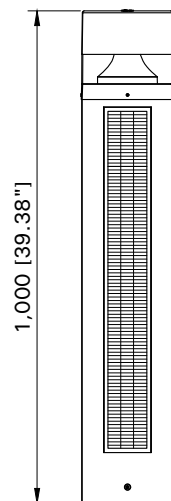
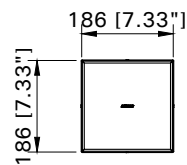

MOUNTING DETAIL

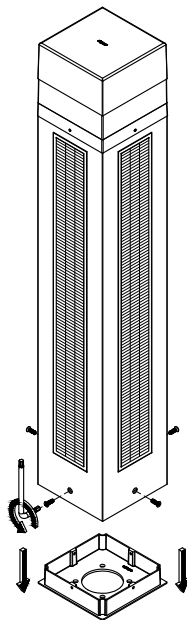

①

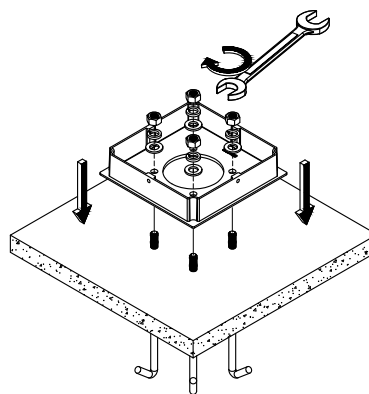

②

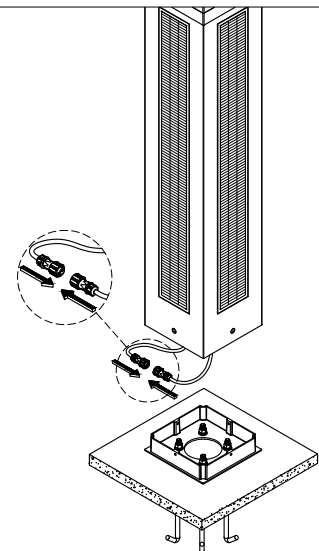

③

Connection cable between  
solar and battery

### Notice to installer :

**1. WIRING INSTRUCTIONS** Warning : RISK OF FIRE AND ELECTRICAL SHOCK. : FIXTURE MUST BE INSTALLED BY A QUALIFIED ELECTRICIAN ONLY>FIXTURE IS INTENDED FOR INSTALLATION IN ACCORDANCE WITH THE NATIONAL ELECTRICAL CODE, LOCAL AND FEDERAL CODE SPECIFICATIONS. DISCONNECT POWER BEFORE SERVICING.

**2.** This fixture has a **VOLTAGE SPECIFIC BALLAST**, Check that the supply voltage is the same as the installed ballast voltage.

**Ligman Lighting USA**

7144 NE Progress Court, Hillsboro  
Oregon, 97124, USA  
Tel : 503 645 0500 | Fax : 503 645 8100

